



Magle Bay

Anglemont

SHUSWAP LAKE

Subject Property

Eagle Bay

Eagle Bay Estates
Electoral Area C



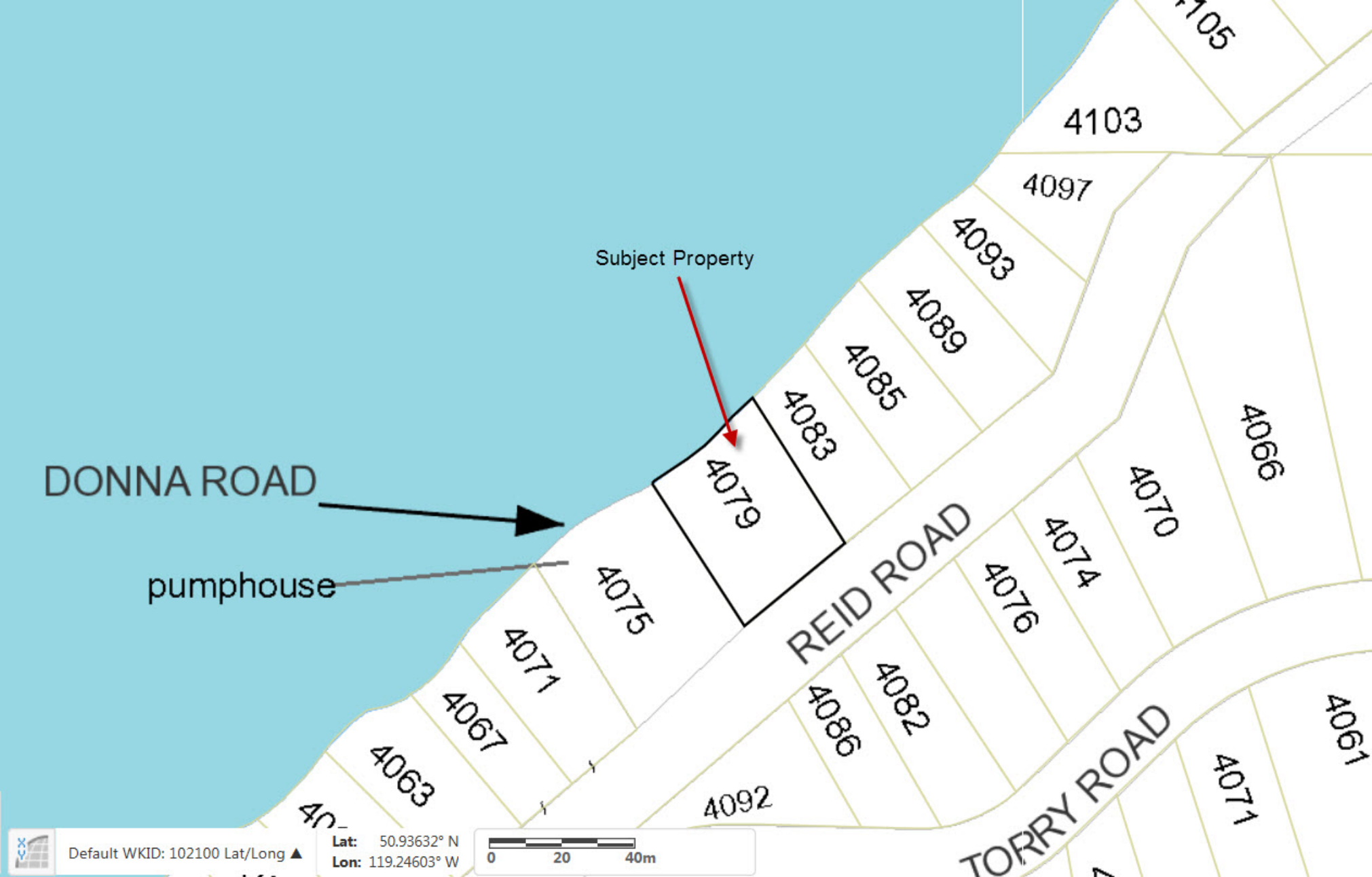

DONNA ROAD

Subject Property

pumphouse

4079

REID ROAD

TORRY ROAD

Default WKID: 102100 Lat/Long ▲

Lat: 50.93632° N

Lon: 119.24603° W

0 20 40m

FW

RR

MERLYN ROAD

Subject Property

Bylaw 725

DONNA ROAD

pumphouse

REID ROAD

TORRY ROAD

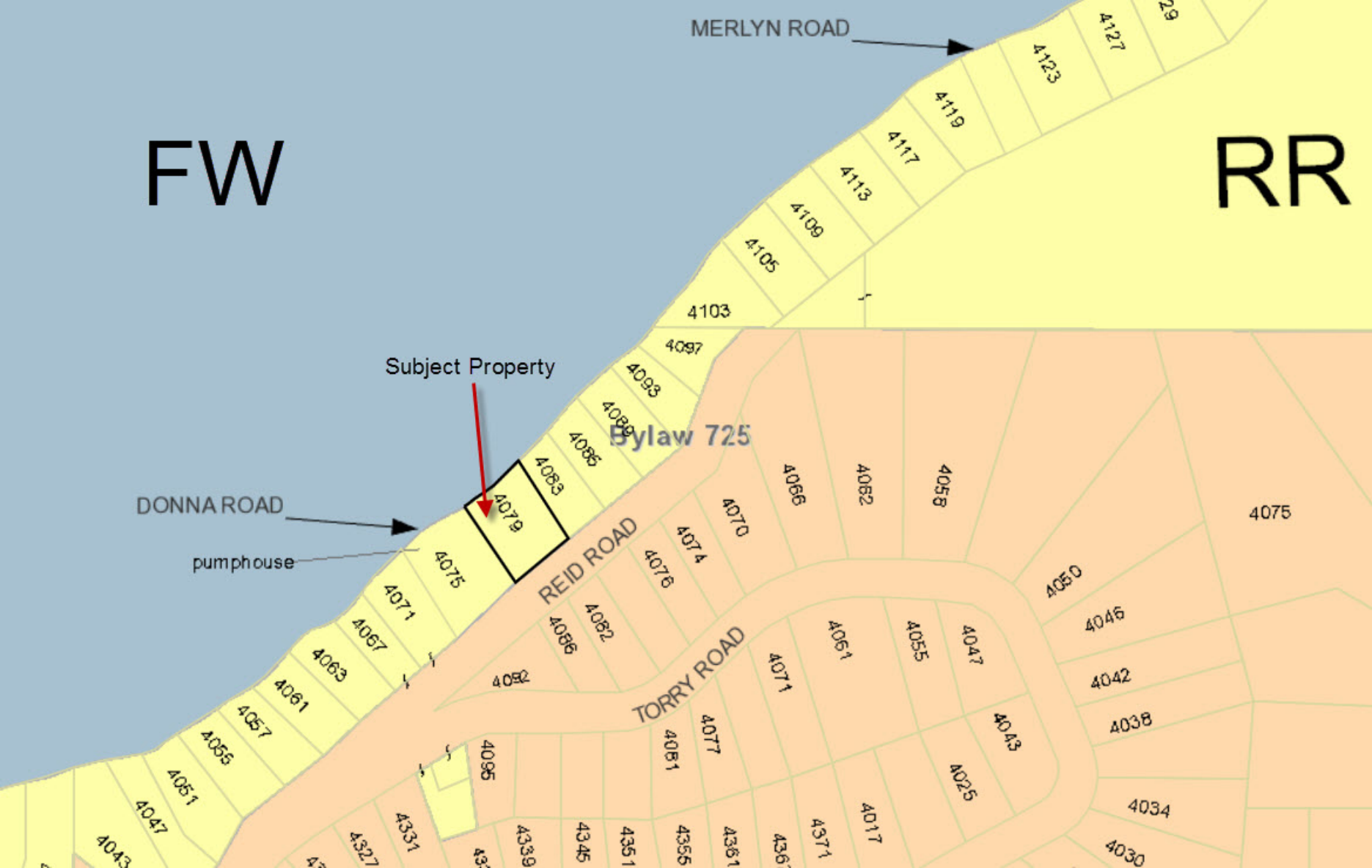

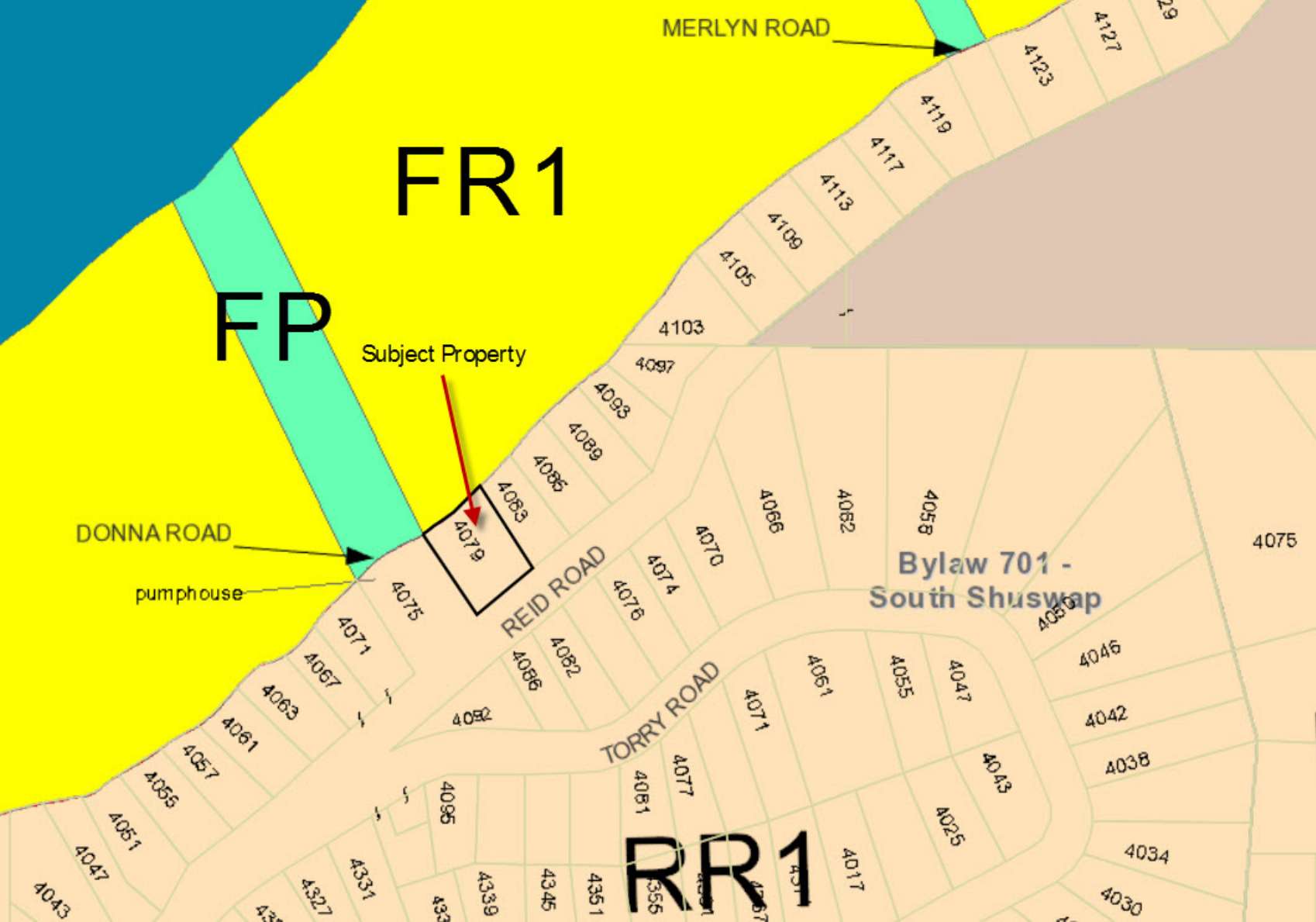

FR1

FP

Subject Property

DONNA ROAD

pumphouse

REID ROAD

TERRY ROAD

Bylaw 701 -
South Shuswap

RR1

SUBJECT PROPERTIES



Shuswap Foreshore and Inventory Mapping, 2008

Legend

999 Foreshore Inventory and Mapping (FIM) Segment Number
 Segment Break

- Cadastre
- Contours
- Abandoned Dock
- Access
- Boat Launch
- Creek / River Mouth
- Discharge
- Imported Sand
- Lighthouse Marker
- Rail
- Raptor Nest
- Rock Outcrop
- Seepage
- Slide
- Miscellaneous Field Point



Shoreline Features
 Little River Sockeye Spawning

- High Density Spawning
- Low Density Spawning

Aquatic Habitat Index Rating

- Very High
- High
- Moderate
- Low
- Very Low

Shore Type

- Cliff / Bluff
- Gravel Beach
- Rocky Shore
- Sand Beach
- Stream Mouth
- Wetland
- Other

Milfoil Density

- Dense - 71 to 100% Cover
- Moderate - 31 to 70% Cover
- Sparse - 11 to 30% Cover
- Present - 10% or Less Cover

Vegetation

- Emergent Vegetation (EV)
- Emergent Vegetation and Overhanging Vegetation (EVOV)



EBES

Donna Rd

Buoys in front of pumphouse



This buoy marks the intake

Looking west from boat launch on Lot 16



03.21.2018

Facing east from boat launch



03.21.2018

E
LAKE BAY ESTATES
SOCIETY (1985)
PRIVATE PROPERTY
NO LOADING OR UNLOADING
NO PARKING ON TOWNSHIP PROPERTY
PAID MEMBERS
AND GUESTS ONLY

03.21.2018

Day parking area on Donna Road
(pumphouse lot)



03.21.2018