



DEVELOPMENT VARIANCE PERMIT NO. 825-48

OWNERS: C & C Capital Investments Inc.
56 Kenton Woods Lane
Spruce Grove, AB
T7X 0P8

1. This Development Variance Permit is issued subject to compliance with all the Bylaws of the Regional District applicable thereto, except as specifically varied or supplemented by this Permit.
2. This Permit applies only to the lands described below:

Lot A Section 1 Township 23 Range 11 West of the 6th Meridian Kamloops Division Yale District Plan 14636 (PID: 008-972-044), which property is more particularly shown outlined in bold on the Location Map attached hereto as Schedule A.
3. The Scotch Creek/Lee Creek Zoning Bylaw No. 825, is hereby varied as follows:
 - a. Section 5.7(3)(g) Maximum floor area, gross, of an accessory building from 150 m² to 205.15 m²,

as more particularly shown on the site plan and drawings attached hereto as Schedule B.
3. This Permit is NOT a building permit.

AUTHORIZED AND ISSUED BY RESOLUTION of the Columbia Shuswap Regional District Board on the _____ day of _____, 2025.

CORPORATE OFFICER

NOTE: Subject to Section 504 of the Local Government Act, if the development of the subject property is not substantially commenced within two years after the issuance of this permit, the permit automatically lapses.

Schedule A
Location Map

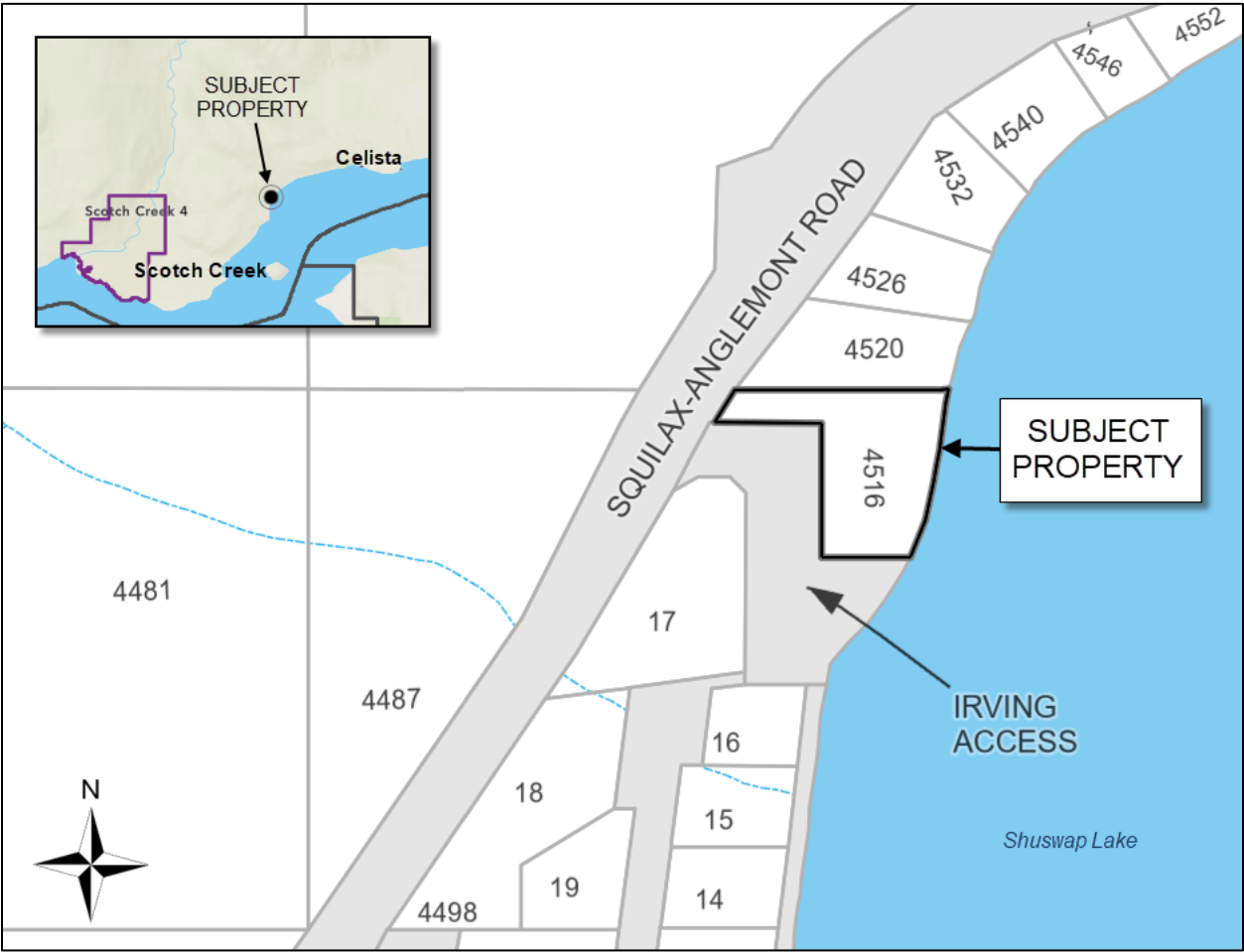

Schedule B

Site Plan and Drawings

