

COLUMBIA SHUSWAP REGIONAL DISTRICT

SCOTCH CREEK/LEE CREEK ZONING AMENDMENT BYLAW NO. 825-52

A bylaw to amend the "Scotch Creek/Lee Creek Zoning Bylaw No. 825"

The Board of the Columbia Shuswap Regional District, in open meeting assembled, hereby enacts as follows:

1. "Scotch Creek/Lee Creek Zoning Bylaw No. 825" is hereby amended as follows:

A. TEXT AMENDMENT

Schedule A, Zoning Bylaw Text, is hereby amended by:

- i. Adding to Section 5.9(4) after (a):

(b) Notwithstanding subsection (3)(c) for Lot 1, Section 33, Township 22, Range 11, W6M, KDYD, Plan 11667 except Plan 35199, as shown on the map below, the maximum density of manufactured home spaces where not serviced by a *community sewer system* shall be ten per ha (one per 0.25 ac). 8 manufactured home spaces shall be connected to one approved shared sewage system and 28 manufactured home spaces shall be serviced by 14 approved onsite sewage disposal systems (2 manufactured home spaces per system). All sewage systems shall be constructed in accordance with the Sewerage System Regulation.

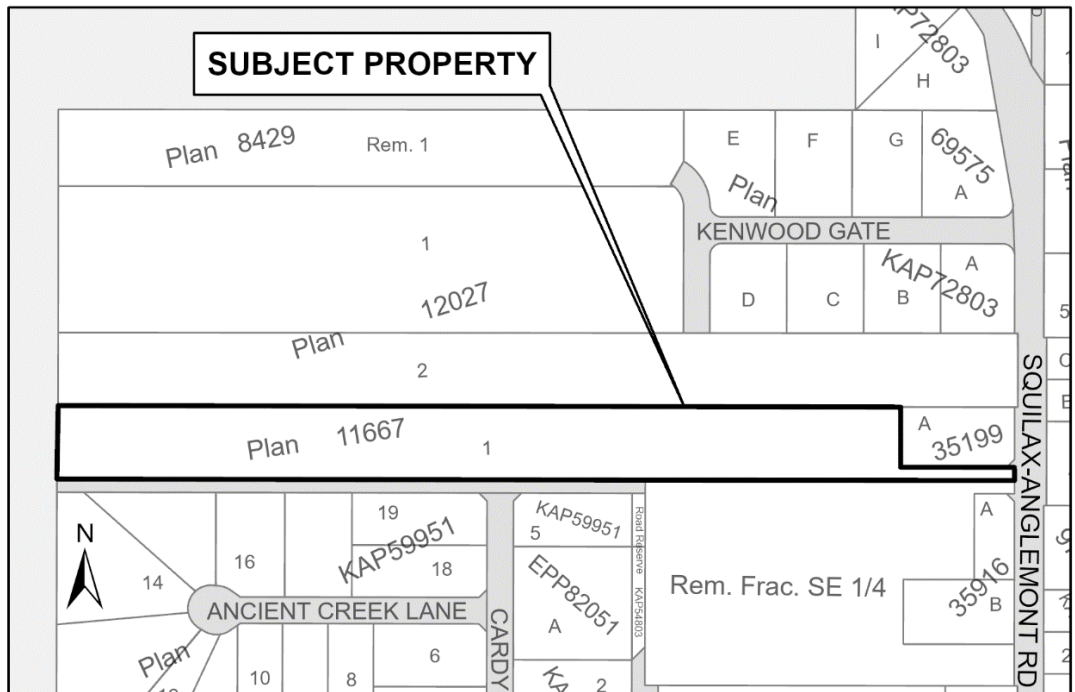

2. This bylaw may be cited as "Scotch Creek/Lee Creek Zoning Amendment Bylaw No. 825-52."

READ a first time this _____ day of _____, 2024.

READ a second time this _____ day of _____ 2024.

PUBLIC HEARING held this _____ day of _____, 2024.

READ a third time this _____ day of _____, 2024.

ADOPTED this _____ day of _____, 2024.

CORPORATE OFFICER

CHAIR

CERTIFIED a true copy of Bylaw No. 825-52 as read a third time.

CERTIFIED a true copy of Bylaw No. 825-52 as adopted.

Corporate Officer

Corporate Officer