

COLUMBIA SHUSWAP REGIONAL DISTRICT

SCOTCH CREEK/LEE CREEK ZONING
AMENDMENT (TED & LUCILLE TASH) BYLAW NO. 825-37

A bylaw to amend the "Scotch Creek/Lee Creek Zoning Bylaw No. 825"

WHEREAS the Board of the Columbia Shuswap Regional District adopted Bylaw No. 825;

AND WHEREAS the Board deems it appropriate to amend Bylaw No. 825;

NOW THEREFORE the Board of the Columbia Shuswap Regional District in open meeting assembled, HEREBY ENACTS as follows:

1. "Scotch Creek/Lee Creek Zoning Bylaw No. 825", as amended, is hereby further amended as follows:

A. TEXT AMENDMENT

- i. Schedule A, Zoning Bylaw Text, Part 5 – Zones, Section 5.7 Residential - 1 is hereby amended by adding subsection 4 (ss), in its entirety, including the attached map.

"(ss) Notwithstanding subsection (3), on Strata Lot 1, Section 27, Township 22, Range 11, West of 6th Meridian, KDYD, Strata Plan K227 as shown hatched on the map below, the following supplemental regulations for a proposed new single family dwelling shall be permitted:

- .1 Notwithstanding subsection 3(c), the maximum parcel coverage for the proposed new single family dwelling is 75.24%.
- .2 Notwithstanding subsection 3(f), the minimum setbacks for the proposed new single family dwelling are as follows:

(f) Minimum <i>setback</i> from:	
▪ <i>front parcel boundary</i>	▪ 0.0 m (0.0 ft.)
▪ <i>interior side parcel boundary</i> (west side)	▪ 0.0 m (0.0 ft.)
▪ <i>interior side parcel boundary</i> (east side)	▪ 0.246 m (0.808 ft.)
▪ <i>rear parcel boundary</i>	▪ 0.388 m (1.273 ft.)

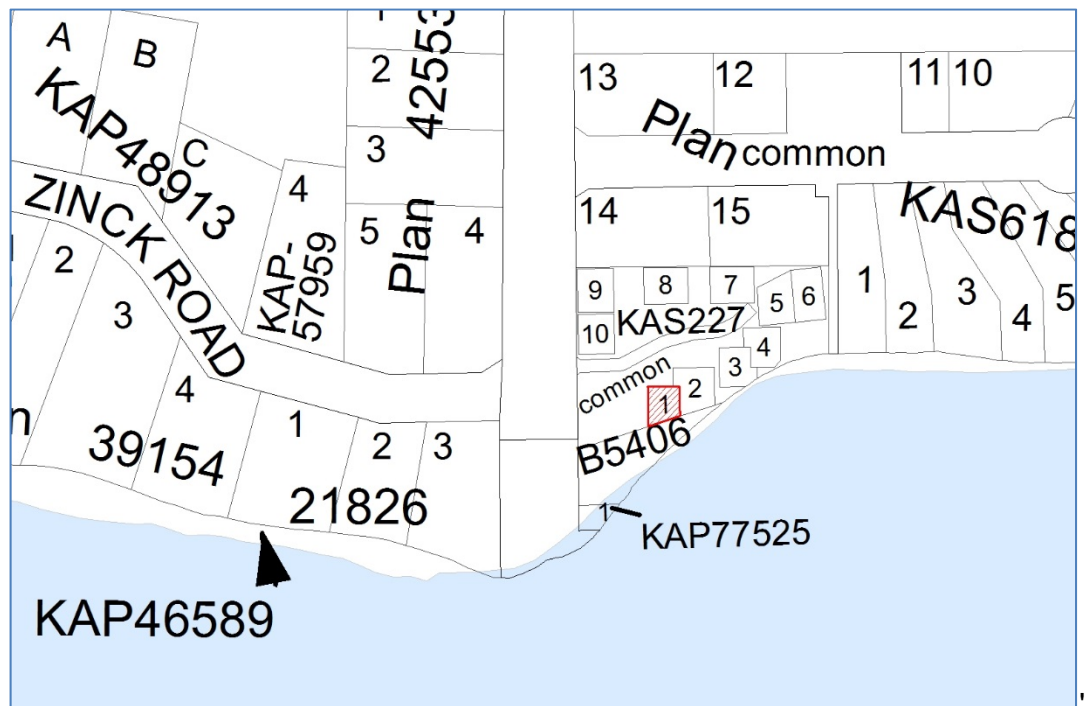

2. This bylaw may be cited as " Scotch Creek/Lee Creek Zoning Amendment (Ted & Lucille Tash)
Bylaw No. 825-37"

READ a first time this 15 day of October, 2015.

READ a second time this 21 day of September, 2017.

PUBLIC HEARING held this 17 day of October, 2017.

READ a third time this _____ day of _____, 2017.

ADOPTED this _____ day of _____, 2017.

CHIEF ADMINISTRATIVE OFFICER

CHAIR

CERTIFIED true copy of Bylaw No. 825-37
as read a third time.

CERTIFIED true copy of Bylaw No. 825-37
as adopted.

Chief Administrative Officer

Chief Administrative Officer