

Lakes Zoning Amendment Bylaw No. 900-36E

Maps_Plans_Photos

1. Area covered by Lakes Zoning Bylaw No. 900

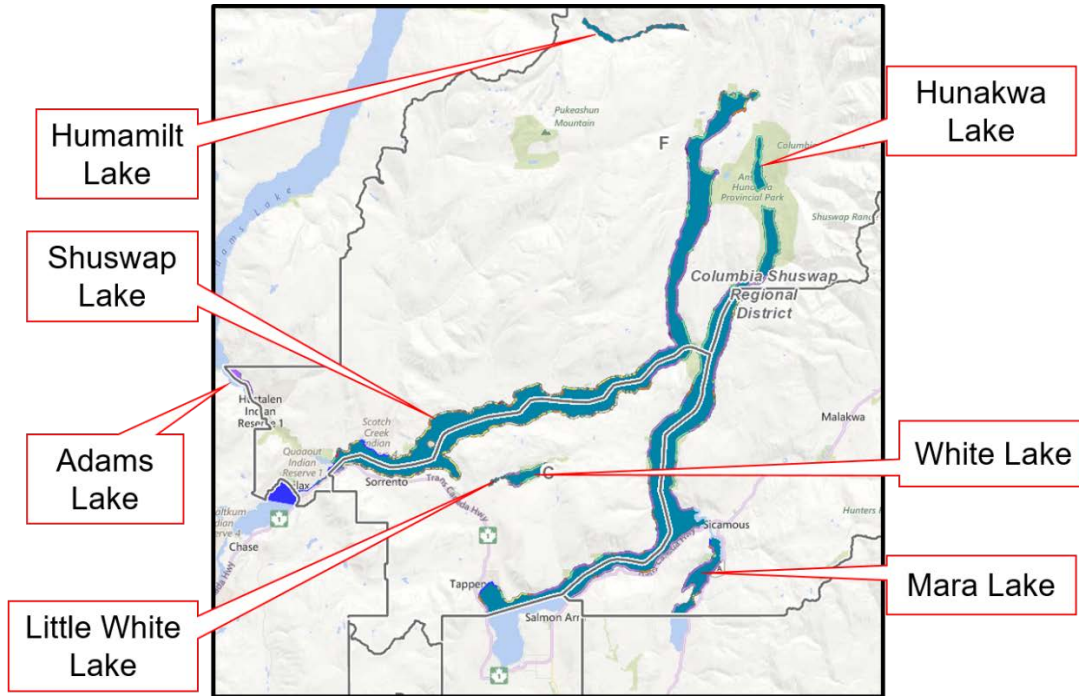

2. Location – 9940 Mara West Road

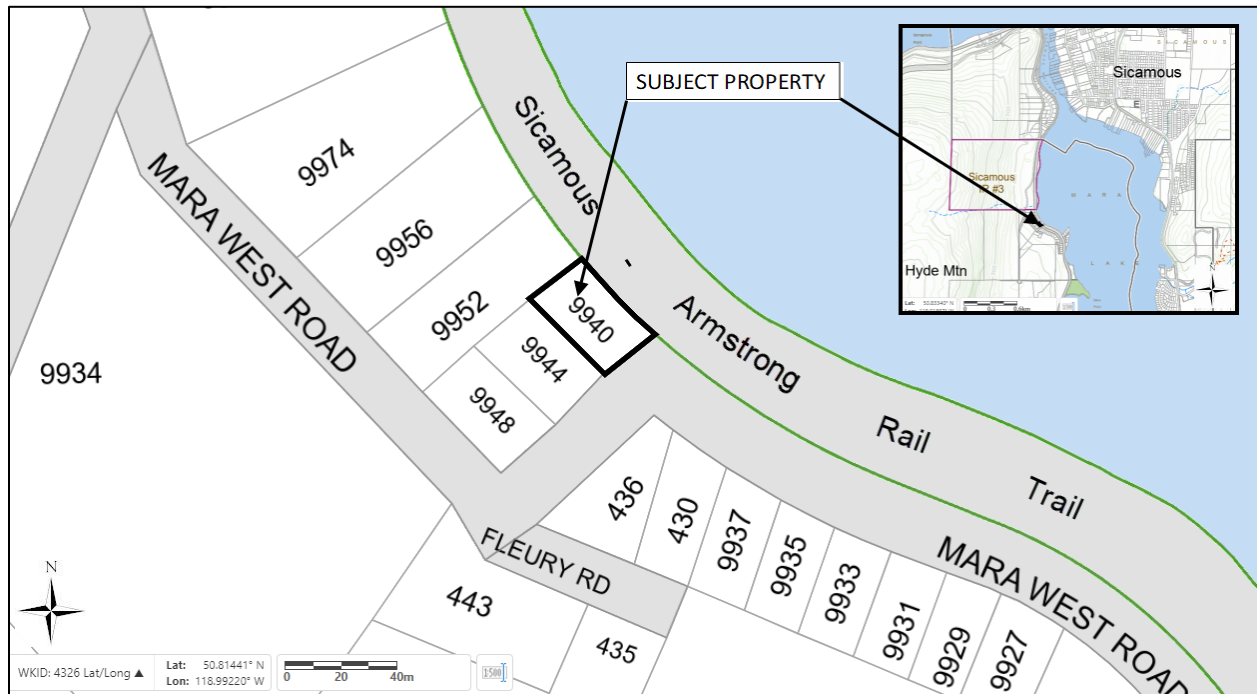

3. Electoral Area E Zoning Bylaw No. 841 & Lakes Zoning Bylaw No. 900

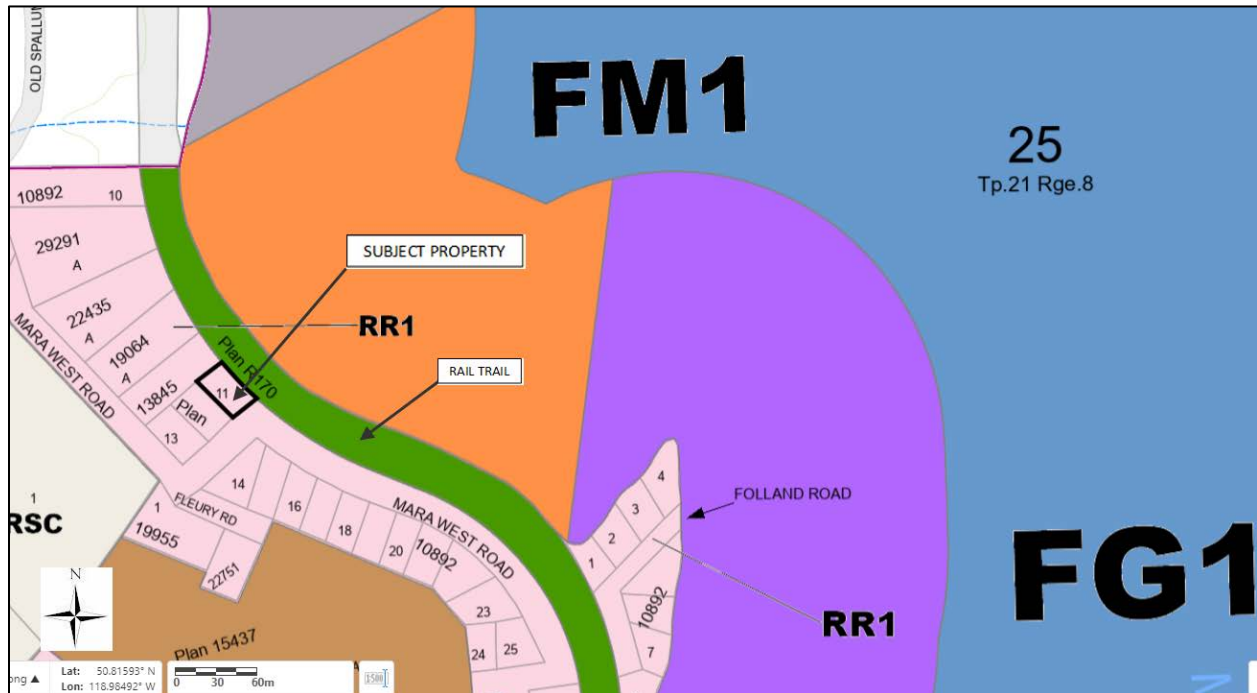

4. Electoral Area E Official Community Plan Bylaw No. 840

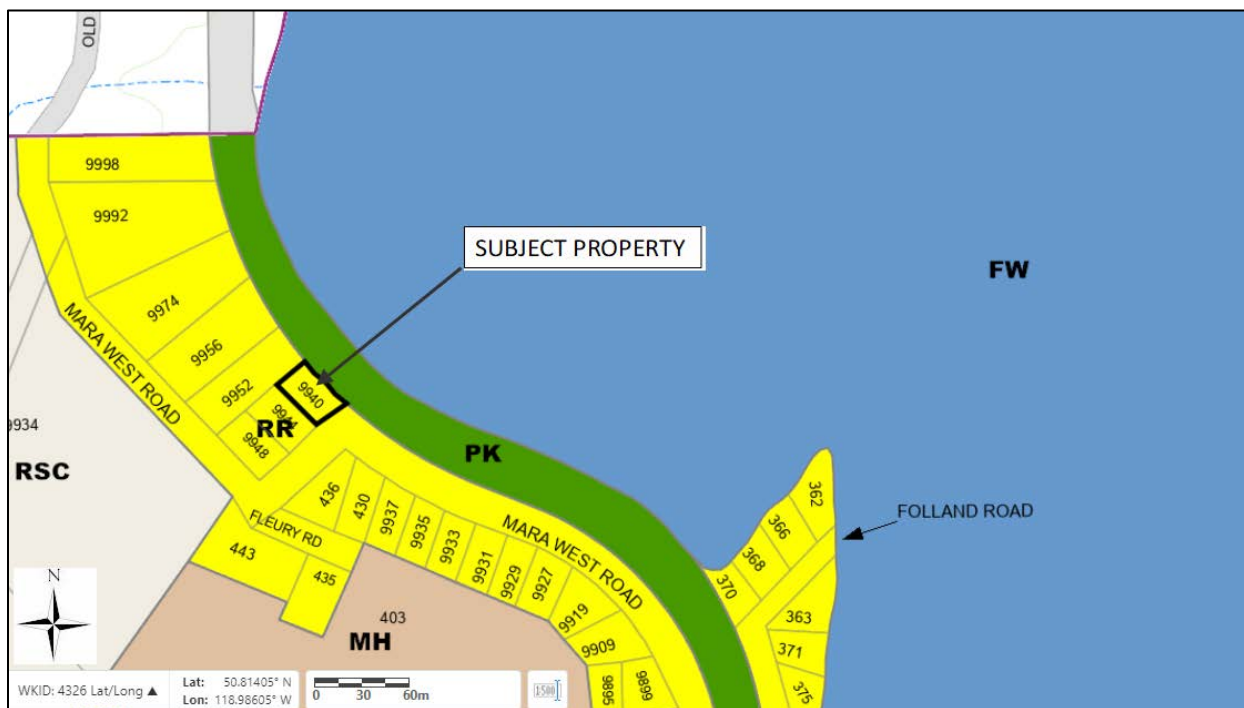

5. Proposed Rezoning

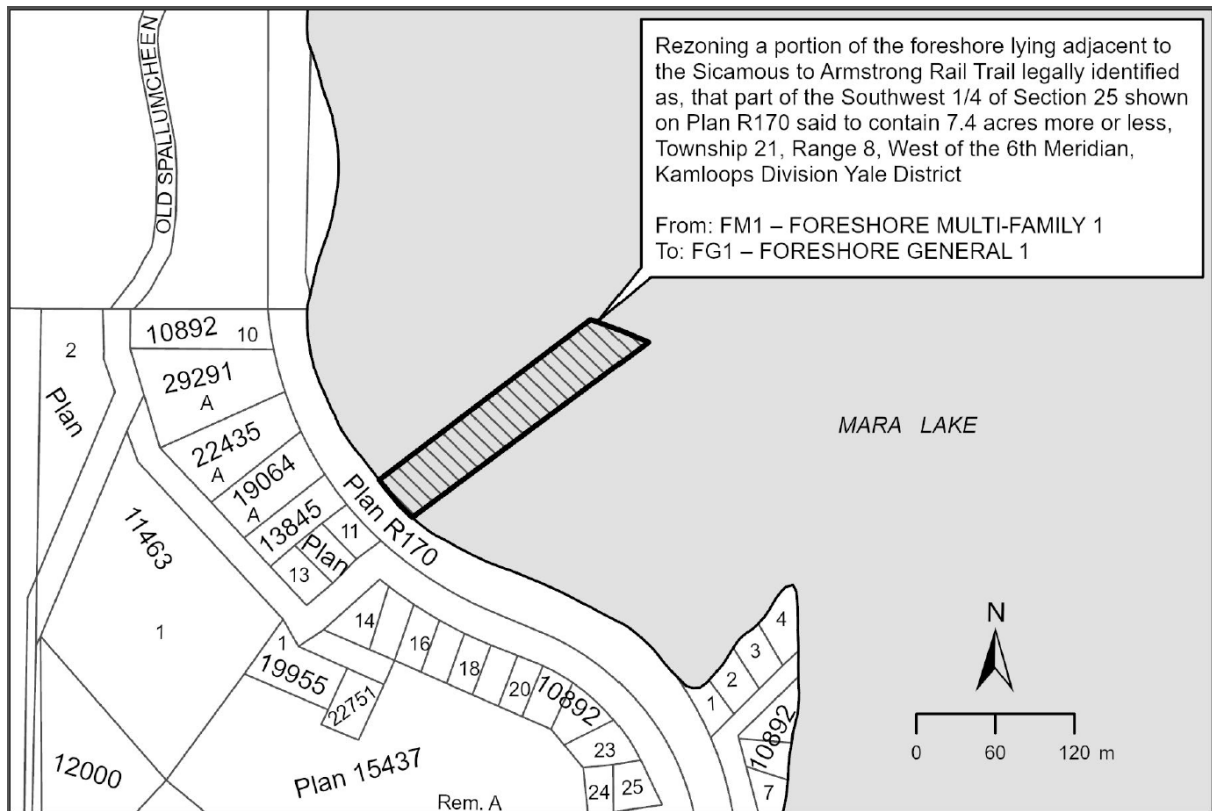

6. Orthophotos



Only pilings in place in 2013





7. 2013 Oblique Photo



8. 2015 Photo taken by CSRD Bylaw Enforcement showing partially constructed dock

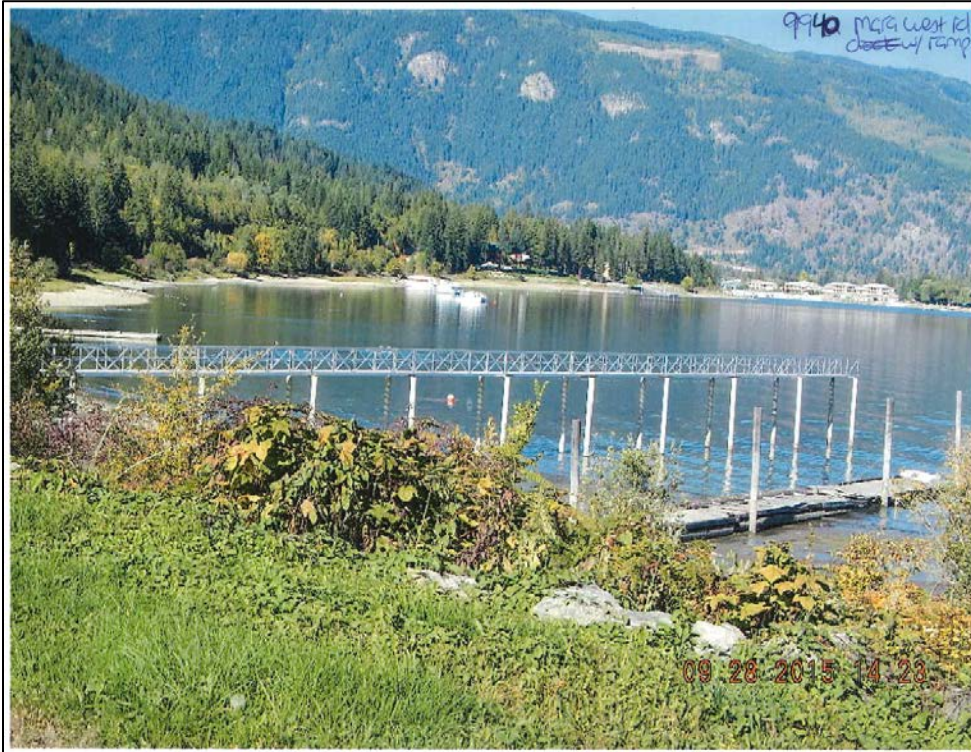

9. Photo of dock provided by applicant

