

DEVELOPMENT VARIANCE PERMIT NO. 641-25

1. OWNER: Lot 1 & 2, Plan KAP82925: Linda Franklin
3710 Sunnybrae Canoe Point Road
Tappen BC V0E 2X1
2. This permit applies only to the lands described below:

Lot 1, Sections 2 and 11, Township 21, Range 10, West of the 6th Meridian, Kamloops Division Yale District, EPP _____ (PID _____),
which the parent properties are more particularly shown outlined in bold on the map attached hereto as Schedule 'A'.
3. The Subdivision Servicing Bylaw No. 641, is hereby varied as follows:

Schedule 'A' – Levels of Service, Minimum Parcel Size for new subdivisions within a Secondary Settlement Area where not serviced by both a Community Water System and a Community Sewer System is varied from 1.0 ha to a minimum of 0.837 ha for new Lot 1, EPP _____ of the proposed 2 lot boundary adjustment subdivision, as shown on Schedule 'B'.
4. This is NOT a building permit.

AUTHORIZED AND ISSUED BY the Columbia Shuswap Regional District Board on the 15th day of June, 2017.

CORPORATE OFFICER

NOTE: Subject to Section 504 of the Local Government Act, if the development of the subject property is not substantially commenced within two years after the issuance of this permit, the permit automatically lapses.

DVP 641-25
Schedule A

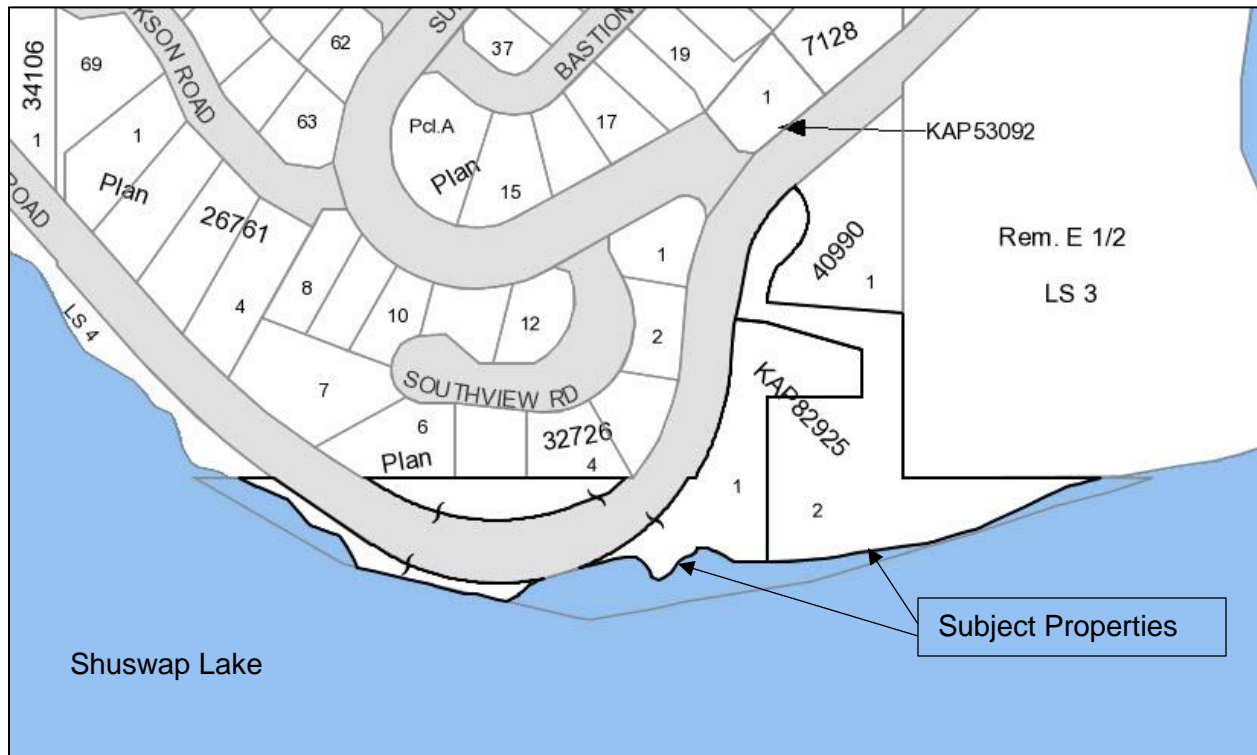

DVP 641-25
Schedule B

