

DEVELOPMENT VARIANCE PERMIT NO. 2500-18

1. OWNERS: Kathleen Porter

[REDACTED]  
[REDACTED]

Jacqueline Gingras

[REDACTED]  
[REDACTED]

*As joint tenants*

2. This permit applies only to the land described below:

Lots 1 & 2, Block 2, Section 2, Township 18, Range 12, W6M, KDYD, Plan 1295, which property is more particularly shown outlined in bold/hatched on the map attached hereto as Schedule 'A'.

3. The Salmon Valley Land Use Bylaw No. 2500, is hereby varied as follows:

Section 2.7.2 Minimum setback from the front parcel line for an existing single family dwelling from 6 m to 4.78 m;

Section 2.7.2 Minimum setback from the exterior parcel line for an existing single family dwelling from 4.5 m to 3.48 m;

Section 2.7.2 Minimum setback from the exterior side yard for an existing garage from 4.5 m to 0 m; and

Section 2.7.2 Minimum setback from the rear parcel line for an existing garage from 5 m to 0 m.

as more particularly shown on the site plan for the proposed subdivision prepared by Browne Johnson Land Surveyors under File: 155-19, attached hereto as Schedule 'B'.

4. This is NOT a building permit.

AUTHORIZED AND ISSUED BY RESOLUTION of the Columbia Shuswap Regional District Board on the \_\_\_\_\_ day of \_\_\_\_\_, 2019.

---

DEPUTY CORPORATE OFFICER

NOTE: Subject to Section 504 of the Local Government Act, if the development of the subject property is not substantially commenced within two years after the issuance of this permit, the permit automatically lapses.

**COLUMBIA SHUSWAP REGIONAL DISTRICT**  
**Development Variance Permit 2500-18**  
 Schedule 'A'

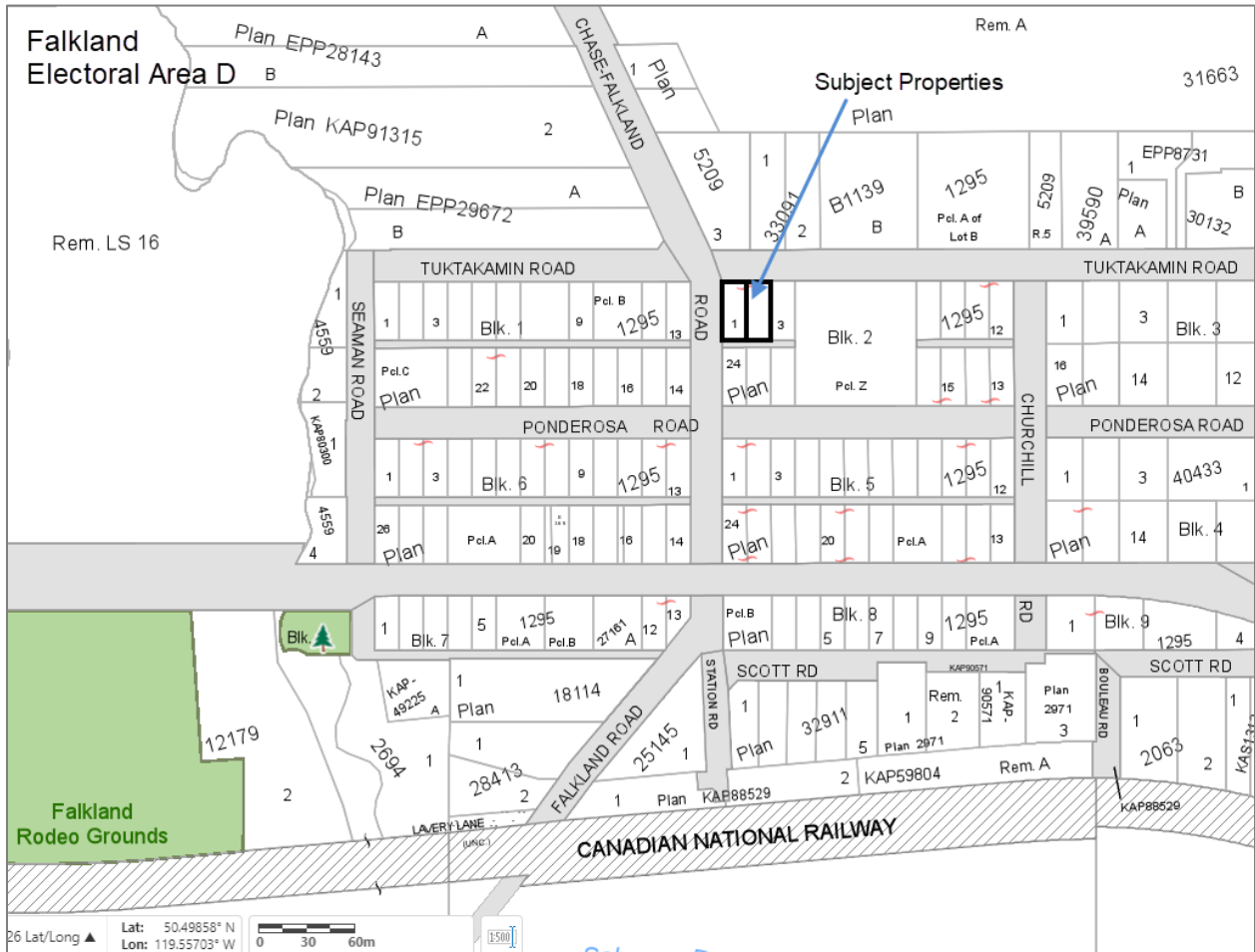

\*Note: Subject properties are in the process of a boundary adjustment subdivision to realign the internal lot line as shown on the site plan on page 3 of this permit.

**COLUMBIA SHUSWAP REGIONAL DISTRICT**  
**Development Variance Permit 2500-18**  
 Schedule 'B'

Site Plan for  
 Plan of Subdivision of  
 Lots 1 and 2, Block 2,  
 Sec 2, Tp 18, R 12,  
 W6M, KDYD, Plan 1295

BCGS 82L.059

The intended plot size of this plan is 280mm in width by 432mm in height (B size) when plotted at a scale of 1:250

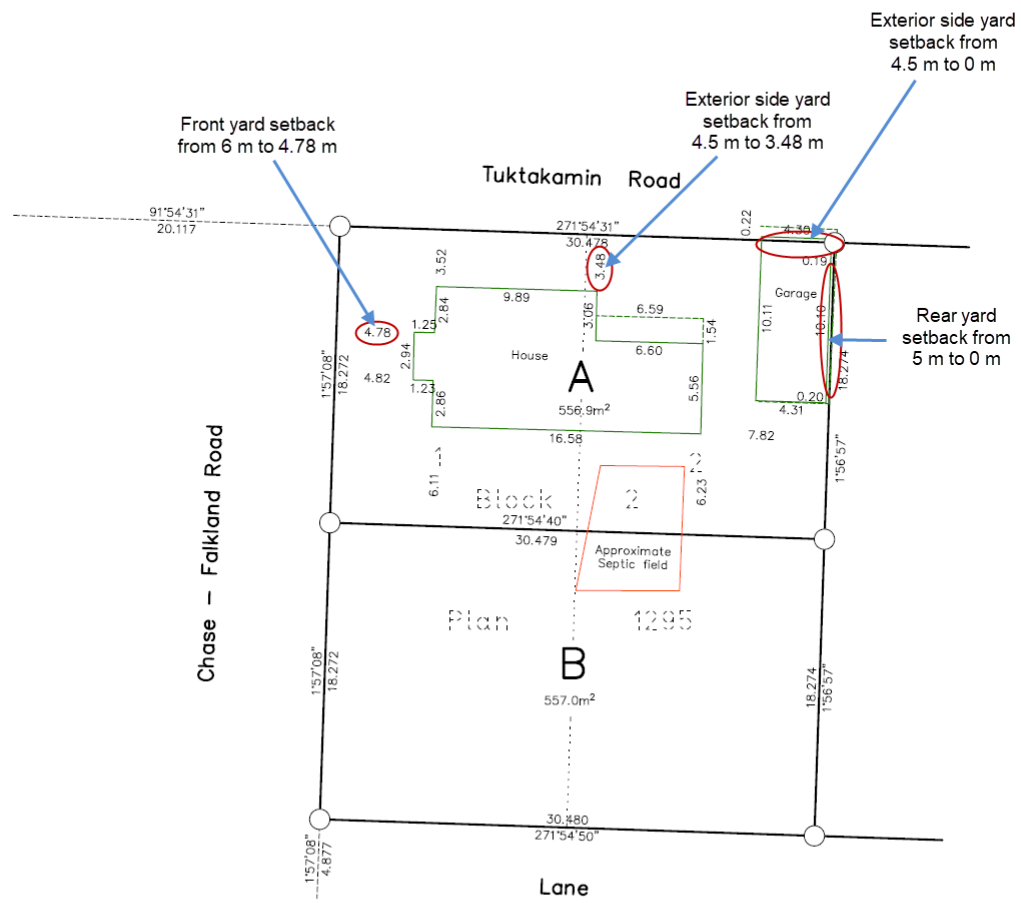

BROWNE JOHNSON LAND SURVEYORS  
 B.C. AND CANADA LANDS  
 SALMON ARM, B.C. 250-832-9701  
 File: 155-19 Fb\_R127p.46-51  
 155-19.raw