



COLUMBIA SHUSWAP REGIONAL DISTRICT

DEVELOPMENT VARIANCE PERMIT NO. 2000-74

1. OWNERS: Beverly Riddoch  
Donald Riddoch



*As joint tenants*

2. This permit applies only to the land described below:

Lot 10 Section 11 Township 21 Range 8 West of the 6<sup>th</sup> Meridian Kamloops Division Yale District Plan 13300 (PID: 003-173-038),

which property is more particularly shown on the map attached hereto as shown outlined in bold and hatched on Schedule A.

3. The Rural Sicamous Land Use Bylaw No. 2000, is hereby varied as follows:

- a. Section 2.12(2)(d) Minimum interior side parcel boundary line setback from 2 m to 0.05 m for the shed on skids;
- b. Section 2.12(2)(d) Exterior side parcel boundary from 4.5 m to 2.73 m for the deck attached to the accessory building and to 3.47 m for the single family dwelling; and,
- c. Section 2.12(2)(d) Rear parcel boundary from 4.5 m to 0.71 m for the shed on skids, to 0.76 for the shed on cinder blocks, and to 4.42 m for the accessory building.

as more particularly shown on the site plan attached hereto as Schedule B.

4. This permit is NOT a building permit.

AUTHORIZED FOR ISSUANCE BY RESOLUTION of the Columbia Shuswap Regional District Board on the 19 day of July, 2018.

---

CORPORATE OFFICER

NOTE: Subject to Section 504 of the Local Government Act, if the development of the subject property is not substantially commenced within two years after the issuance of this permit, the permit automatically lapses.

Schedule A

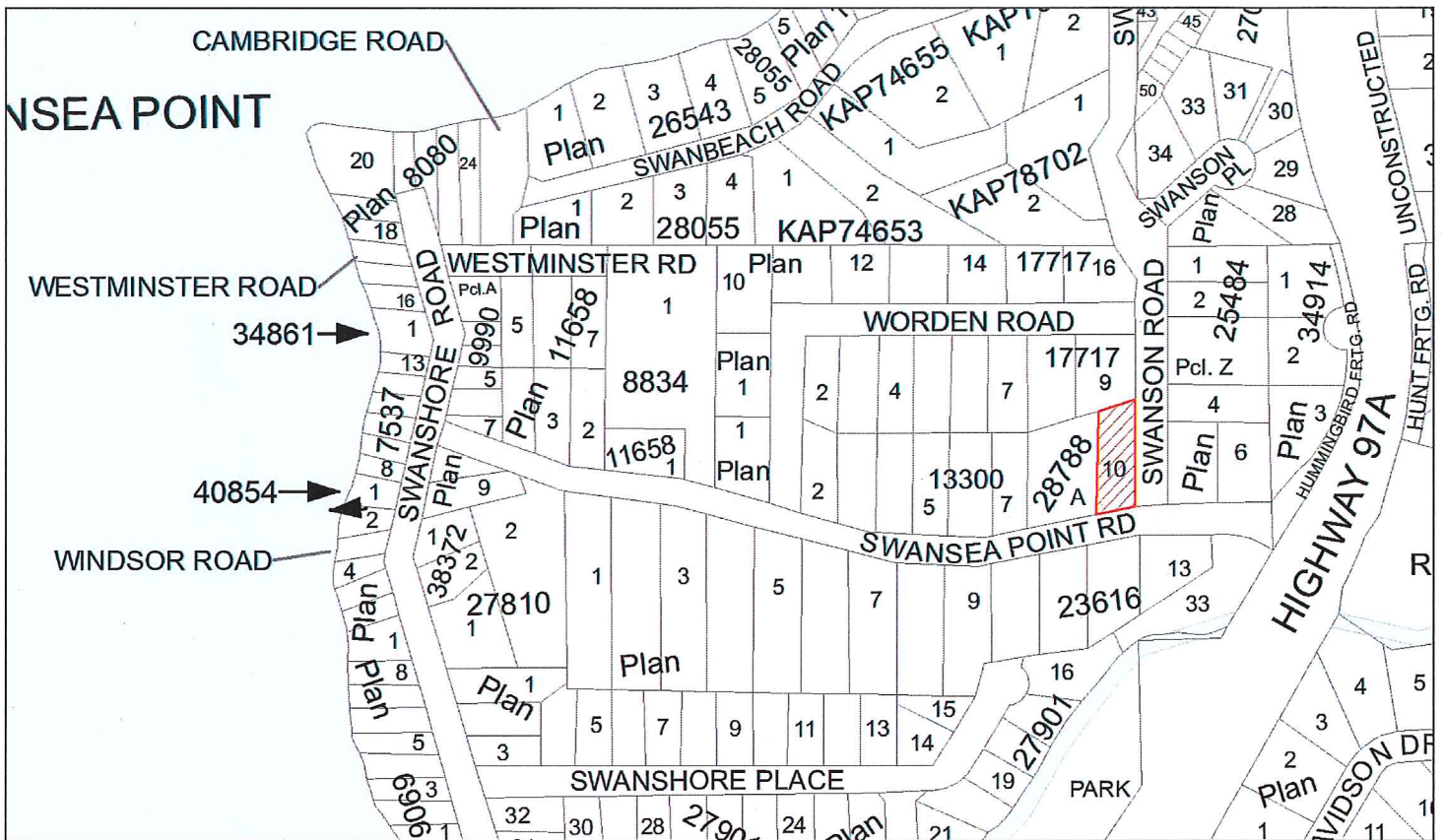

Schedule B

