

COLUMBIA SHUSWAP REGIONAL DISTRICT
ELECTORAL AREA 'B' ZONING AMENDMENT
(EAGLE PASS HELI-SKIING) BYLAW NO. 851-12

A bylaw to amend the "Electoral Area 'B' Zoning Bylaw No. 851"

WHEREAS the Board of the Columbia Shuswap Regional District adopted Bylaw No. 851;

AND WHEREAS the Board deems it appropriate to amend Bylaw No. 851;

NOW THEREFORE the Board of the Columbia Shuswap Regional District in open meeting assembled, HEREBY ENACTS as follows:

1. "Electoral Area 'B' Zoning Bylaw No. 851", as amended, is hereby further amended as follows:

A. TEXT AMENDMENTS

- i) Part 1.0 - Definitions is hereby amended by:

inserting the following definition after "GUEST ACCOMMODATION":

GUEST LOUNGE is an area within a *heli-tourism day lodge* where passengers can wait prior to embarking or after deplaning;

inserting the following definition after "HEIGHT":

HELI-TOURISM DAY LODGE is a building used for heli-tourism business administration, including the embarking and deplaning of passengers for skiing, sightseeing, and other helicopter related tours, *guest lounge*, and washroom facilities;

inserting the following definition after "SMALL-SCALE SAWMILL":

STAFF ACCOMMODATION means a dwelling unit specifically intended as an accessory use to a principal commercial or industrial business to house staff employed by the principal commercial or industrial business.

- ii) Schedule A, Zoning Bylaw Text, Section 5.4 RURAL HOLDINGS RH zone is hereby amended by inserting the following Special Regulation subsection (5) including the attached map as follows:

"Special Regulations

(5) In this subsection, lands are described by legal description and by map. In the event of any discrepancy between the legal description of the lands and the map, the map governs.

(a) Notwithstanding subsection 5.4(2)(a), the following uses are permitted on the portion of the property legally described as SE ¼, Section 25, Township 23, Range 3, West of the 6th Meridian, Kootenay District, Except Parts included in RW Plans 633A and 12984, and Plan R265, lying between the Trans-Canada Highway and the Canadian Pacific Railway as shown on Map 1 below:

- i) *heli-tourism day lodge* (maximum of 2);
- ii) *staff accommodation* for up to 7 persons (maximum of 2); and
- iii) *guest lounge* limited to the area of the main floor of the *heli-tourism day lodges* only.

Map 1

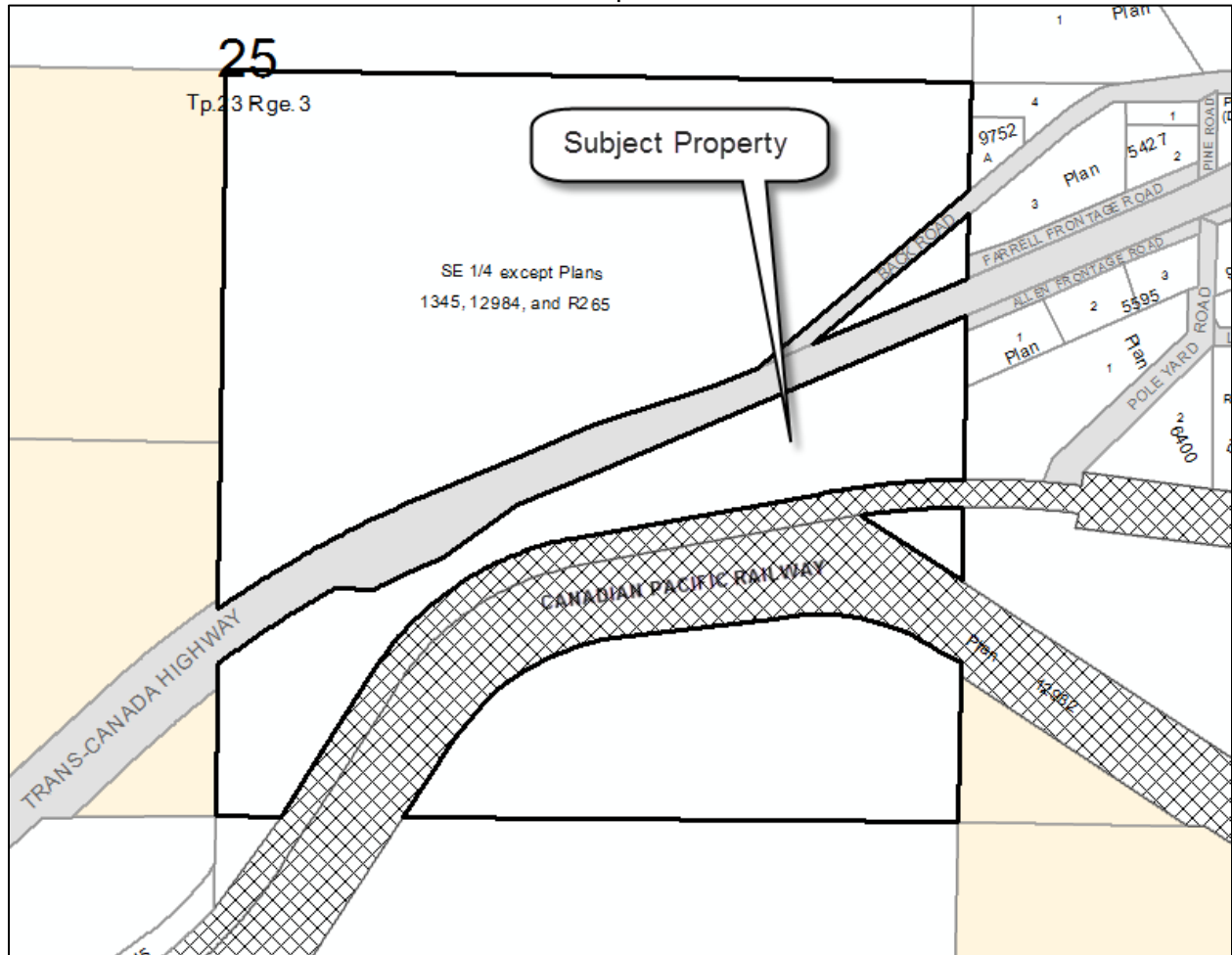

2. This bylaw may be cited as " Electoral Area 'B' Zoning Amendment (Eagle Pass Heliskiing) Bylaw No. 851-12"

READ a first time this _____ 1st _____ day of _____ December _____, 2017.

READ a second time as amended this _____ 19th _____ day of _____ April _____, 2018.

PUBLIC HEARING held this _____ 20th _____ day of _____ June _____, 2018.

READ a third time this _____ day of _____, 2018.

RECEIVED THE APPROVAL of the Ministry of Transportation and Infrastructure this _____ day of _____, 2018.

ADOPTED this _____ day of _____, 2018.

CORPORATE OFFICER

CHAIR

CERTIFIED true copy of Bylaw No. 851-12
as read a third time.

CERTIFIED true copy of Bylaw No. 851-12
as adopted.

Corporate Officer

Corporate Officer